

SMA (Female) Right Angle 4-Hole Field Replaceable Jack
Accepts .009 Pin, DC-18 GHz

SMA2BF59-0009A/9X

P/N	ØA mm [inch]
SMA2BF59-0036A/9X	0.91 [.036]
SMA2BF59-0020A/9X	0.51 [.020]
SMA2BF59-0018A/9X	0.46 [.018]
SMA2BF59-0015A/9X	0.38 [.015]
SMA2BF59-0012A/9X	0.30 [.012]
SMA2BF59-0009A/9X	0.23 [.009]

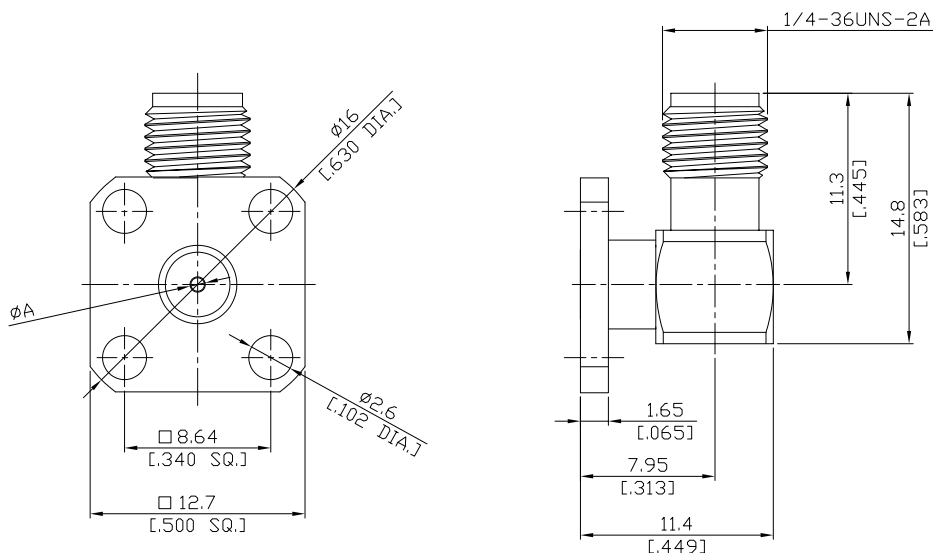

All dimensions are in mm [inch]

Tolerances according to DIN ISO 2768-mH

Interface

According to

IEC 60169-15; MIL-STD-348B/310

Electrical Data

Impedance	50 Ω
Frequency	DC to 18 GHz
VSWR (Return Loss)	$\leq 1.2 + 0.0025 \times F(\text{GHz}) \leq$
Insertion Loss	$0.07 \times \sqrt{F}(\text{GHz}) \text{ dB}$
Insulation Resistance	$\geq 5 \text{ G}\Omega$
Voltage rating	$\geq 1000 \text{ Veff}$
Dielectric withstanding voltage	500 Veff

Material And Plating

Piece Parts	Material	Plating
Centre contact	Beryllium Copper	Gold plating, 3 pinch (Non-magnetic nickel-phosphorus underplating, 80 pinch)
Body	Stainless Steel	Passivated
Insulator	PTFE	

Mechanical Data

Coupling mechanisms	Screw-lock
Mating Cycles	≥ 500
Center Contact Captivation: axial	$\geq 27 \text{ N}$
Weight	N/A
Recommended Torque	0.9 N.m

Environmental Data

Temperature Range	-65°C to +165°C
RoHS	compliant

Packing

Single or 100